

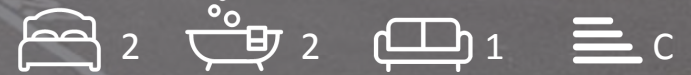

**24 Princess Court, Haywards Heath, RH16 1EF**

**£1,300 PCM**



## Floor Plan

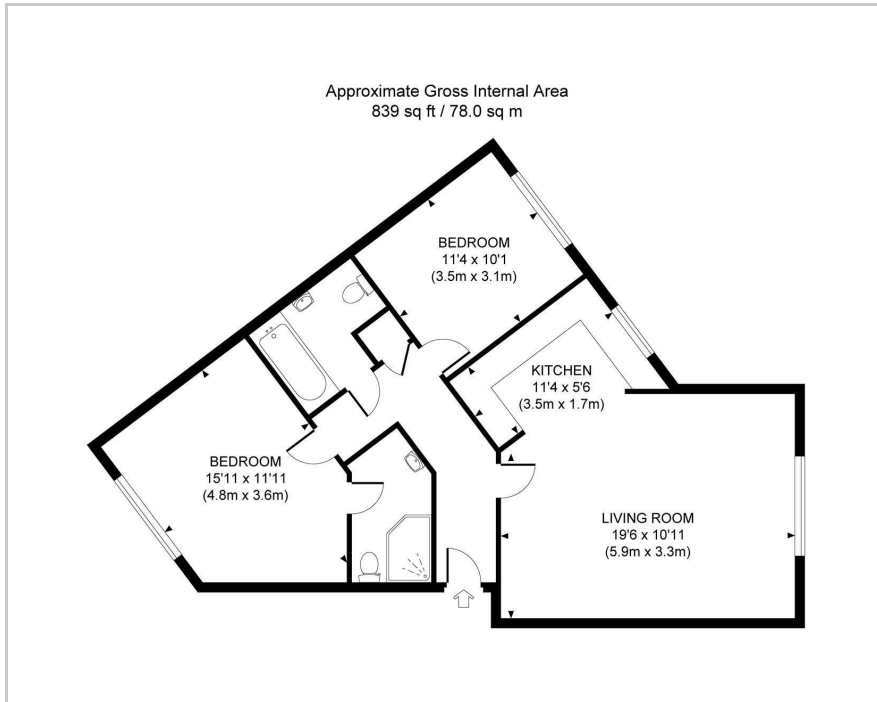

## Area Map

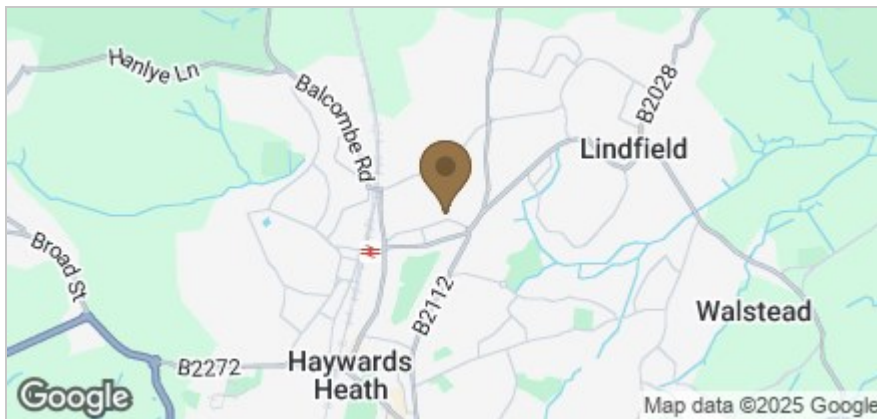

## Accommodation

This beautifully presented ground floor apartment is ideally located close to Haywards Heath mainline station and local amenities, offering both convenience and comfort and ideal for professionals looking for a great location to the station.

Recently redecorated in neutral tones, the accommodation includes a spacious sitting/dining room with an archway leading to a modern kitchen, equipped with a range of units, a fridge/freezer, electric oven and hob, and a washing machine. or professionals.

## Viewing

Please contact us on 01444 455221 if you wish to arrange a viewing appointment for this property or require further information.

## Energy Efficiency Graph

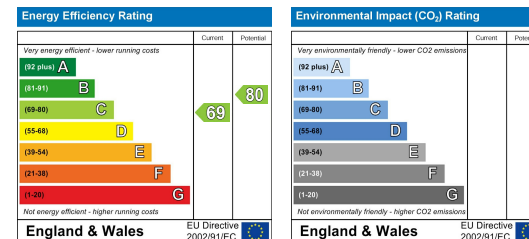

These particulars, whilst believed to be accurate are set out as a general outline only for guidance and do not constitute any part of an offer or contract. Intending purchasers should not rely on them as statements of representation of fact, but must satisfy themselves by inspection or otherwise as to their accuracy. No person in this firm's employment has the authority to make or give any representation or warranty in respect of the property.