



**Middle Village, Bolnore Village, Haywards Heath**  
**Guide Price £249,995 Leasehold**



## 38 Middle Village, Bolnore Village, Haywards Heath, West Sussex, RH16 4GH

### Guide Price £249,995 Leasehold

- **Spacious Apartment:** Generously proportioned 2-bedroom layout with storage cupboards.
- **Open Plan Living:** Bright and airy living room with an adjacent modern kitchen.
- **Primary Bedroom Features:** Includes a walk-in wardrobe and en-suite shower room.
- **Investment Opportunity:** Excellent rental potential, with an estimated income of £1,250-£1,300 PCM.
- **No Onward Chain.**
- **Prime Location:** Situated in the popular Village Square area.
- **Modern Bathroom:** Tiled family bathroom featuring a separate shower cubicle.
- **Parking Convenience:** Allocated parking space with additional visitor parking in the square.
- **Gas Central Heating.**
- **EPC Rating: 'C'**

This generously proportioned apartment offers larger-than-average living space, thoughtfully designed for modern lifestyles. Recently redecorated with new carpets to both bedrooms, the property is presented to a high, turnkey standard, ready for immediate enjoyment.

The wide entrance hall includes a deep double cupboard for ample storage, leading to a bright living room with a Juliet balcony offering roof top and far reaching South Downs views. The modern fitted kitchen is equipped with a stainless steel gas hob, oven, Samsung fridge/freezer, and Bosch washing machine, blending functionality with style.

Both bedrooms are genuine doubles, with the master bedroom featuring a spacious walk-in wardrobe and en-suite shower room. The second family bathroom is fitted with a full-size bath and a separate shower enclosure, catering to both comfort and practicality.

Situated in the heart of the sought-after Bolnore Village, this property benefits from allocated parking, bicycle storage, gas central heating, and double-glazed windows. With its prime location and exceptional presentation, this apartment is a perfect choice for comfort and convenience.

What3words.

Parking space: ///preoccupied.rises.oval

Entrance: ///teach.homes.sake

Village Square: ///noises.daring.swing

- Price: £260,000
- Tenure: Leasehold
- Lease: 150 years from 2005
- Service Charge PA: £2455 (Approx)
- Reserve Fund Contribution: TBC
- Ground Rent PA: £100 (Approx)
- Council Tax Band: 'D'
- EPC Rating: 'C'
- Managing Agents: Bolnore Local Centre Management Group Company.

- Construction: Typically brick built property
- Windows: Double glazed
- Heating: Gas boiler to radiators
- Utilities: Mains supplied gas / Mains supplied water / Mains supplied electricity
- Waste Water/Sewerage: Mains.
- Water Meter: Yes

- Mobile Phone and Broadband Checker: Please verify with 'OFCOM'
- Parking: Residents parking limited to one vehicle per property, with visitor parking in village square.
- Access and Arranged: Stairs from ground floor to first floor
- Title Number(s): WSX289068

We believe the above information to be correct but recommend intending purchasers check details before proceeding to exchange of contracts.



## Floor Plans

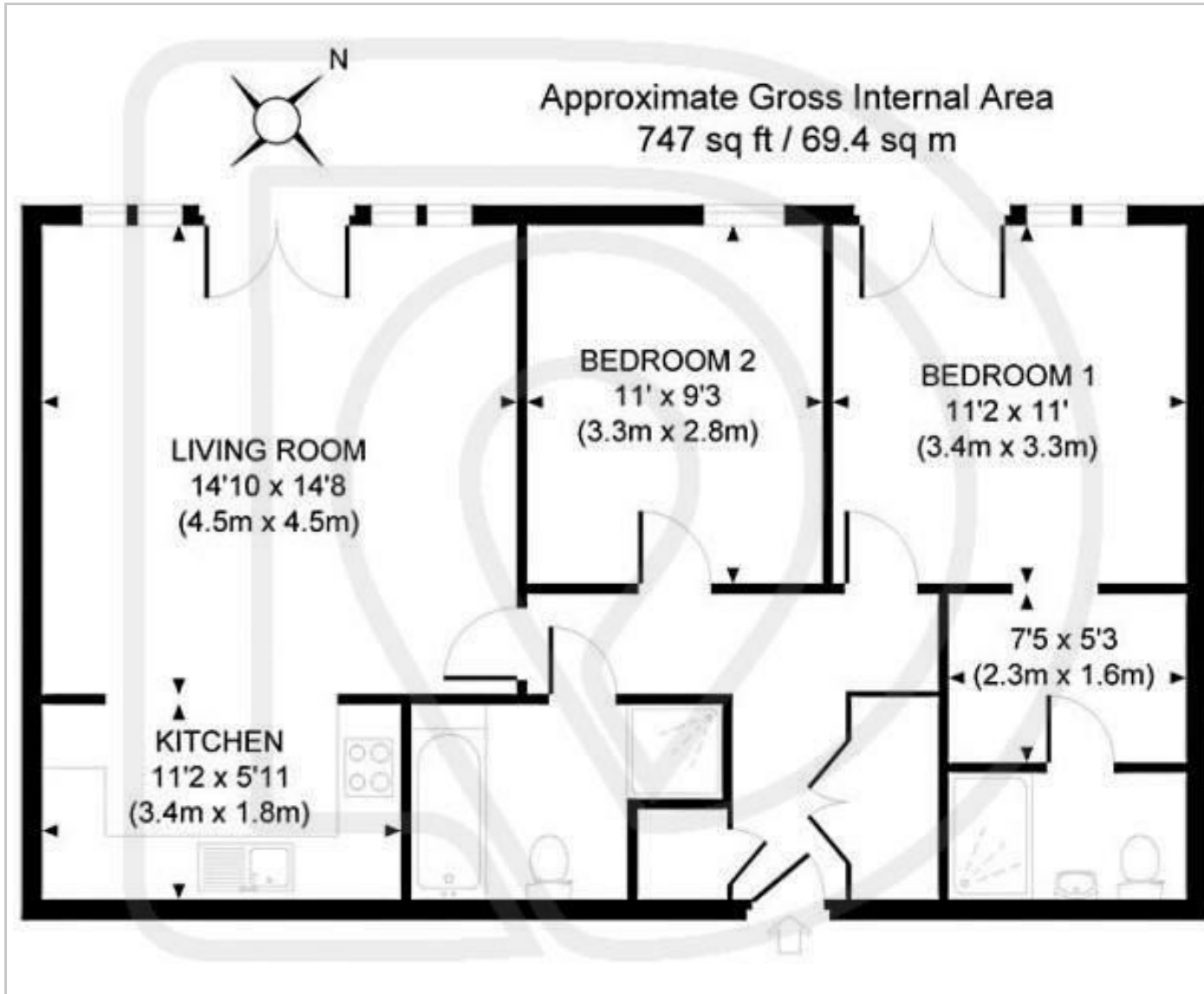

## Area Map

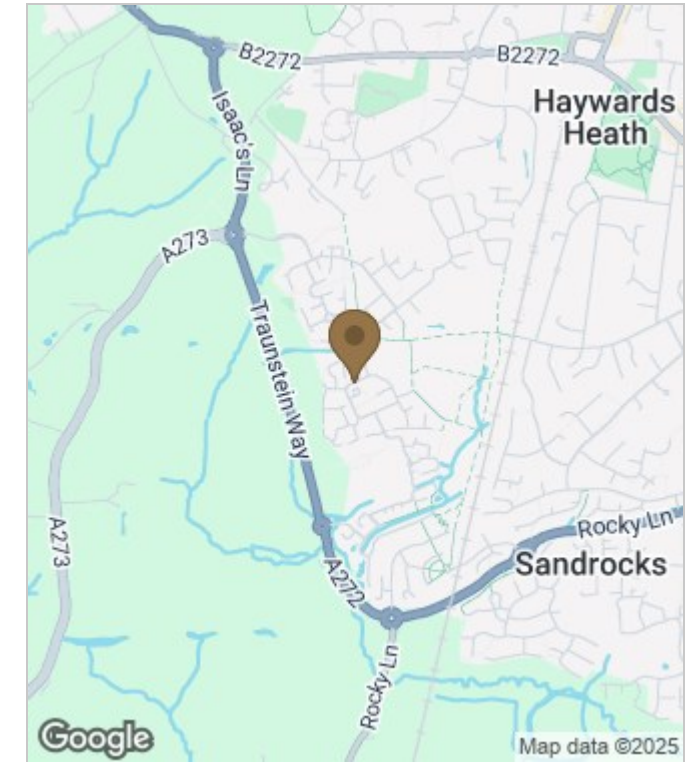

## Energy Performance Graph

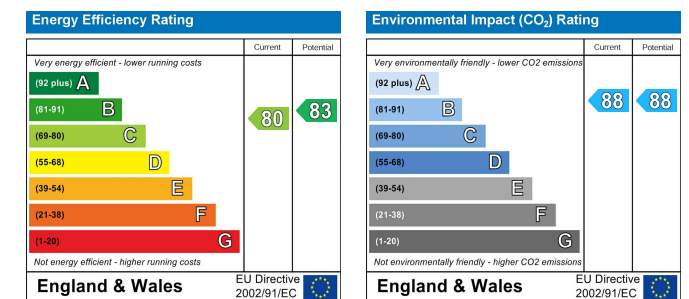

These particulars, whilst believed to be accurate are set out as a general outline only for guidance and do not constitute any part of an offer or contract. Intending purchasers should not rely on them as statements of representation of fact, but must satisfy themselves by inspection or otherwise as to their accuracy. No person in this firm's employment has the authority to make or give any representation or warranty in respect of the property.

49 The Broadway, Haywards Heath, West Sussex, RH16 3AS  
01444 455221 | info@duffyco.com | www.duffyco.com