

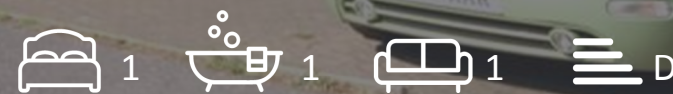

11 Drummond Court Drummond Close, Haywards Heath, RH16 4DE

£950 PCM



Floor Plan

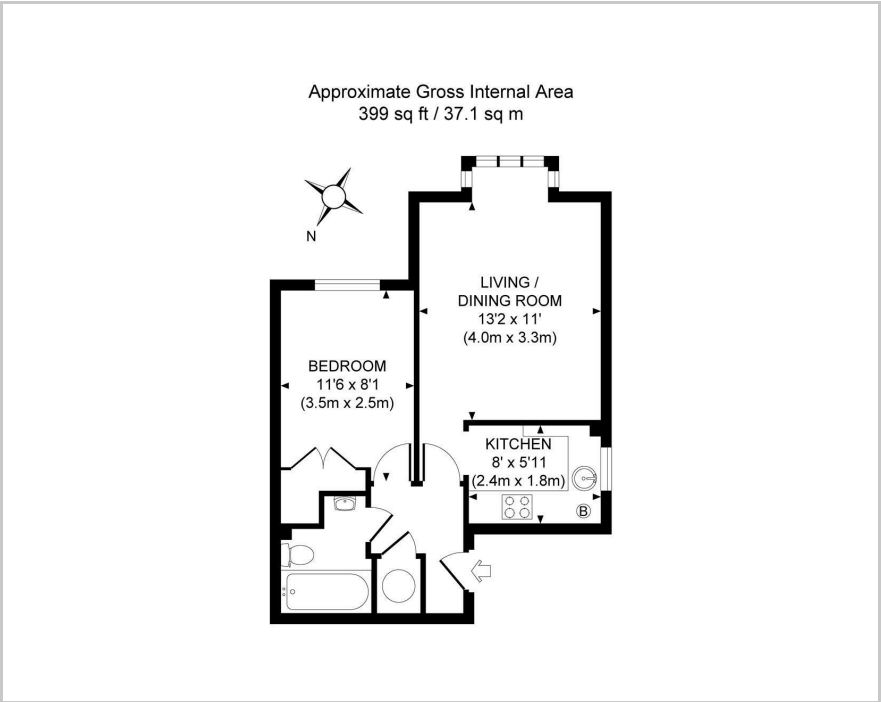

Area Map



These particulars, whilst believed to be accurate are set out as a general outline only for guidance and do not constitute any part of an offer or contract. Intending purchasers should not rely on them as statements of representation of fact, but must satisfy themselves by inspection or otherwise as to their accuracy. No person in this firms employment has the authority to make or give any representation or warranty in respect of the property.

Accommodation

This centrally located top-floor one-bedroom apartment is ideal for single occupancy, catering specifically to mature professionals seeking a comfortable and convenient living space.

With its prime location and practical design, this apartment offers a perfect balance of comfort and accessibility, making it a great choice for those looking for a well-situated home.



Viewing

Please contact us on 01444 455221 if you wish to arrange a viewing appointment for this property or require further information.

Energy Efficiency Graph

