



14 Aspen Court St. Botolphs Road, Worthing, BN11 4JS

£975 Per Month



Floor Plan

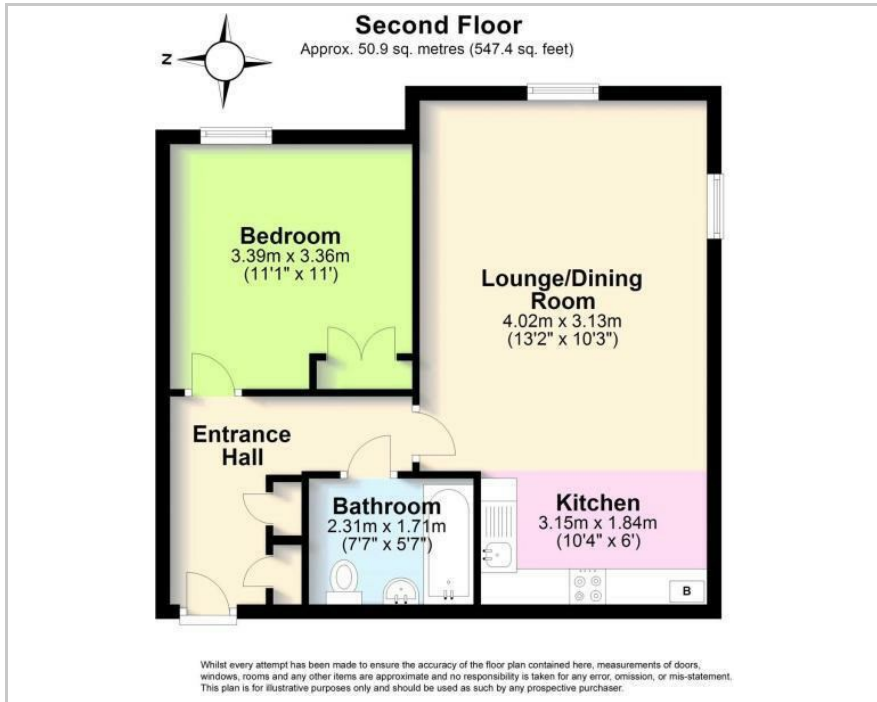

Area Map

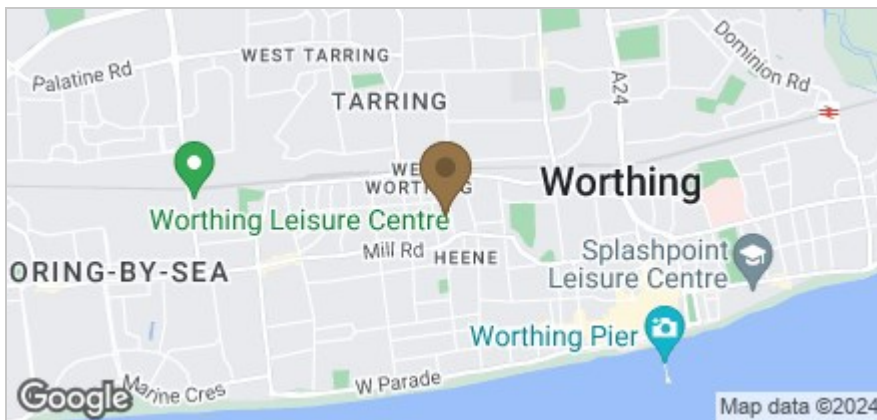

Accommodation

- Top Floor
- Allocated Parking
- Large open plan Kitchen/Living Room
- Double Bedroom
- Walking Distance to West Worthing Station
- Modern Tiled Bathroom
- Utility Cupboard with Washing Machine
- Lift To All Floors
- Gas Heating
- Double Glazed

We are delighted to present this well maintained one-bedroom top floor apartment, situated in the heart of Worthing.

This property is perfectly located just off Tarring Road, offering the ideal blend of convenience and tranquility. With West Worthing Station just a short stroll away, residents will benefit from easy access to public transport, making commuting a breeze.

Viewing

Please contact us on 01444 455221 if you wish to arrange a viewing appointment for this property or require further information.

Energy Efficiency Graph

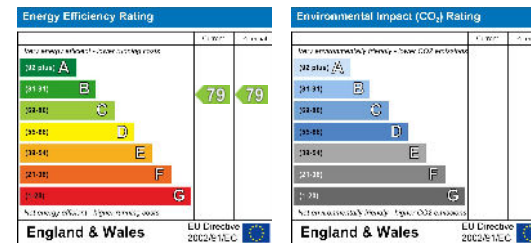

These particulars, whilst believed to be accurate are set out as a general outline only for guidance and do not constitute any part of an offer or contract. Intending purchasers should not rely on them as statements of representation of fact, but must satisfy themselves by inspection or otherwise as to their accuracy. No person in this firm's employment has the authority to make or give any representation or warranty in respect of the property.