



36 Sunte Avenue, Haywards Heath, RH16 2AA

£2,100 Per Month



4



2



2

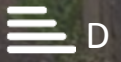

D

Floor Plan

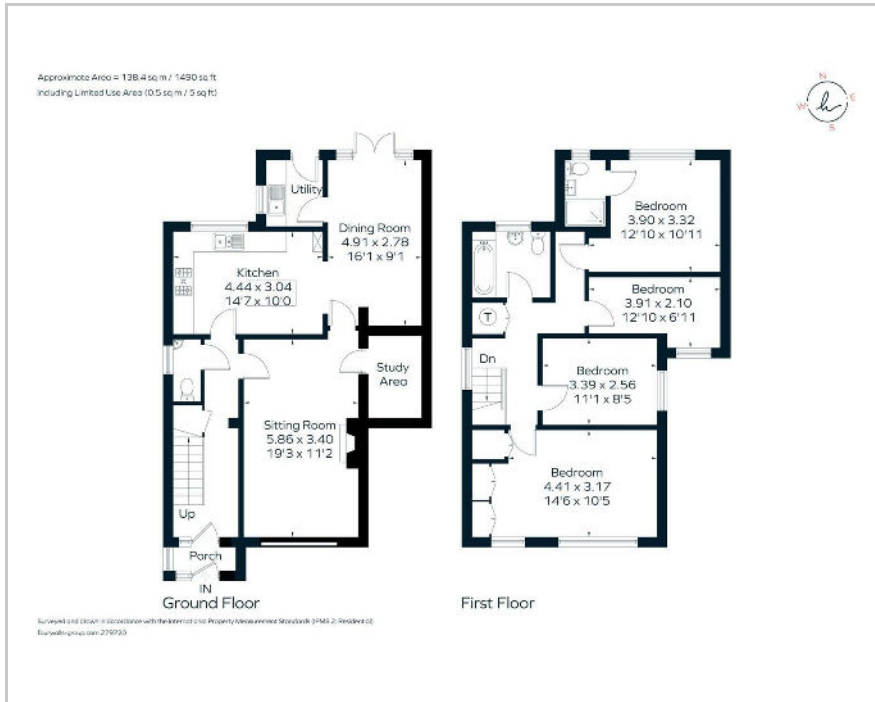

Accommodation

Situated in one of the prime residential streets of Lindfield and Haywards Heath is this well proportioned 4 bedroom detached family home.

The property comprises on the ground floor: entrance porch and hall with separate WC, spacious living room with home office/study adjacent and separate dining room to the rear. There is a lovely family kitchen with range style cooker/oven and American style fridge/freezer with a separate utility room with washing machine and tumble dryer.

On the first floor are 2 large double bedrooms one with en-suite and 2 further smaller doubles and a family bathroom with white suite and shower above the bath.

Outside there is a fairly low maintenance mainly laid to lawn rear garden with timber storage shed and patio area. To the front there is off road parking on the drive.



Area Map

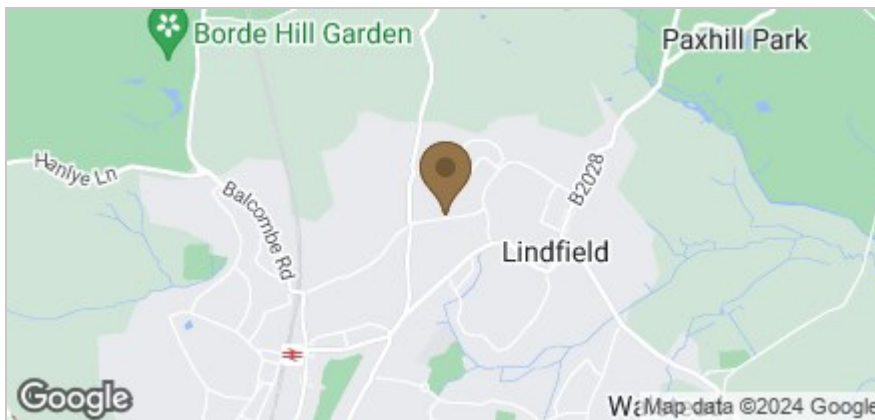

Energy Efficiency Graph

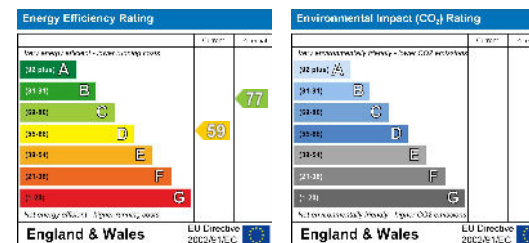

These particulars, whilst believed to be accurate are set out as a general outline only for guidance and do not constitute any part of an offer or contract. Intending purchasers should not rely on them as statements of representation of fact, but must satisfy themselves by inspection or otherwise as to their accuracy. No person in this firm's employment has the authority to make or give any representation or warranty in respect of the property.