

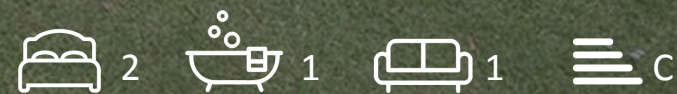

17 Arbor Court Heath Road, Haywards Heath, RH16 3BQ

£1,200 Per Month



Floor Plan

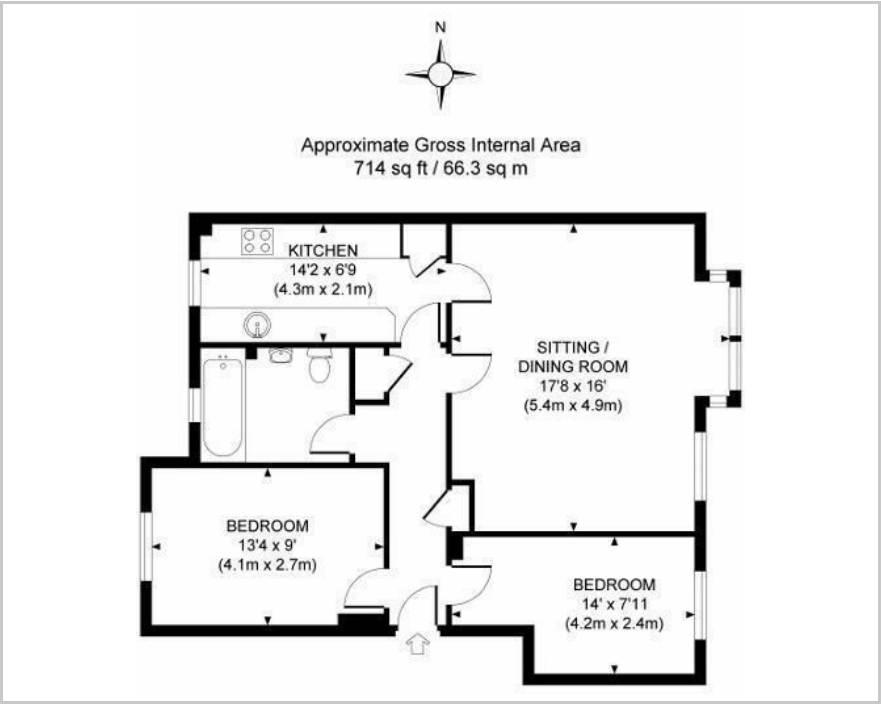

Area Map



These particulars, whilst believed to be accurate are set out as a general outline only for guidance and do not constitute any part of an offer or contract. Intending purchasers should not rely on them as statements of representation of fact, but must satisfy themselves by inspection or otherwise as to their accuracy. No person in this firms employment has the authority to make or give any representation or warranty in respect of the property.

Accommodation

Ideal location for the town centre and station is this very well presented second floor 2 double bedroom apartment that is available late July through Duffy & Co.



Viewing

Please contact us on 01444 455221 if you wish to arrange a viewing appointment for this property or require further information.

Energy Efficiency Graph

