



**14 Highland Court, Haywards Heath, RH16 3NZ**

**£1,200 PCM**



3



2



2

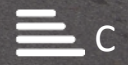

2

## Floor Plan

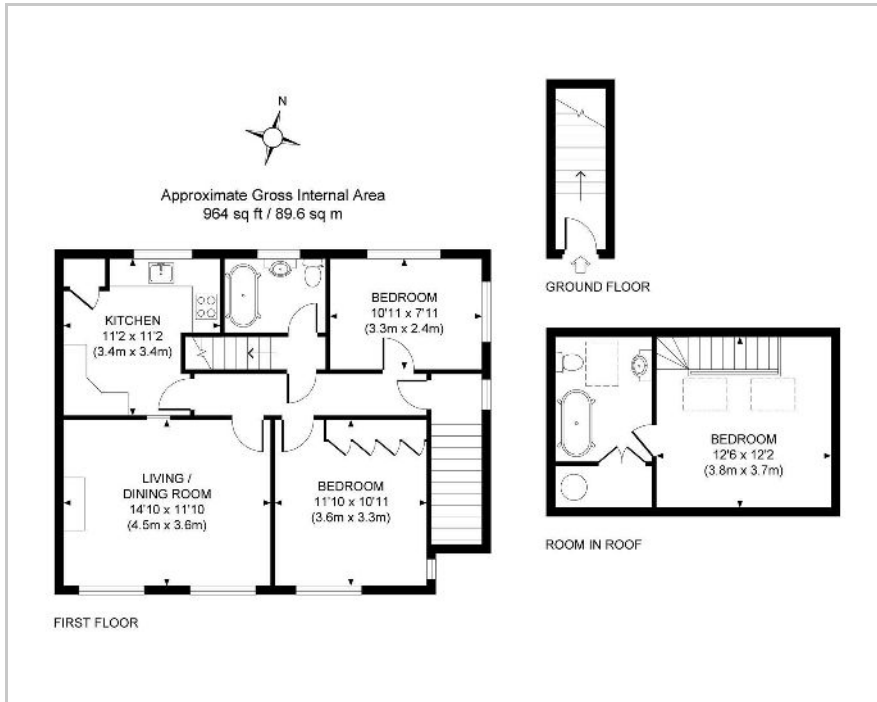

## Area Map



## Accommodation

A three bedroom maisonette located close to the town centre and within walking distance of the mainline station. This property is located in a residential area for mature persons.



## Viewing

Please contact us on 01444 455221 if you wish to arrange a viewing appointment for this property or require further information.

## Energy Efficiency Graph

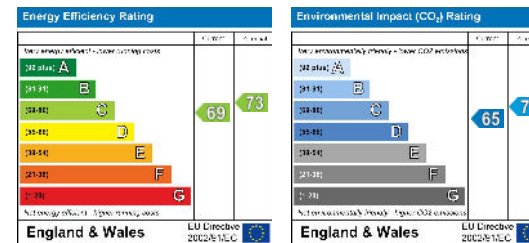

These particulars, whilst believed to be accurate are set out as a general outline only for guidance and do not constitute any part of an offer or contract. Intending purchasers should not rely on them as statements of representation of fact, but must satisfy themselves by inspection or otherwise as to their accuracy. No person in this firm's employment has the authority to make or give any representation or warranty in respect of the property.