



**6 Marle Avenue, Burgess Hill, RH15 8JG**

**£1,525 PCM**





Floor Plan

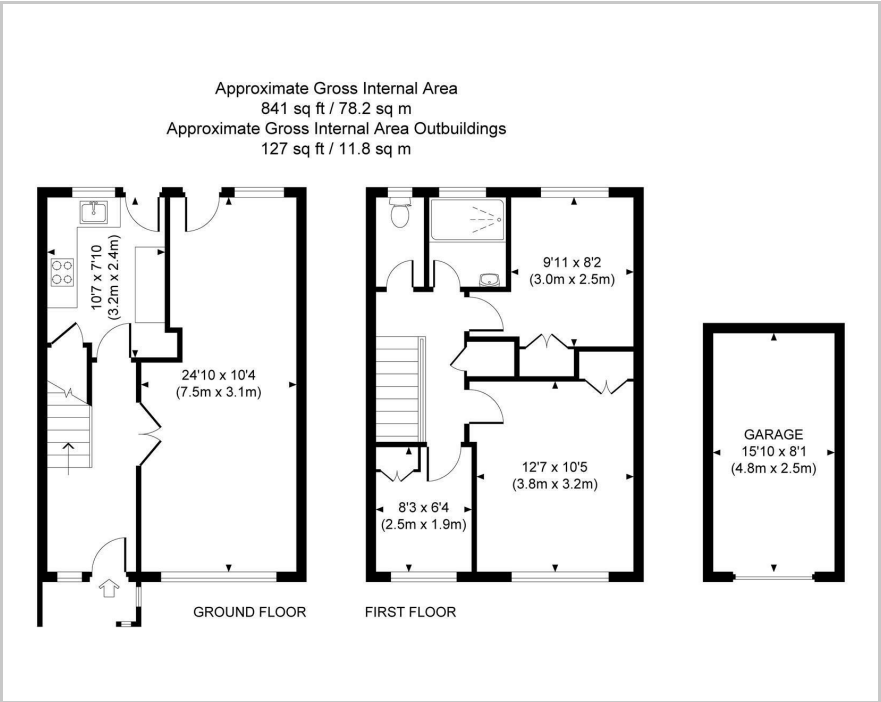

Area Map

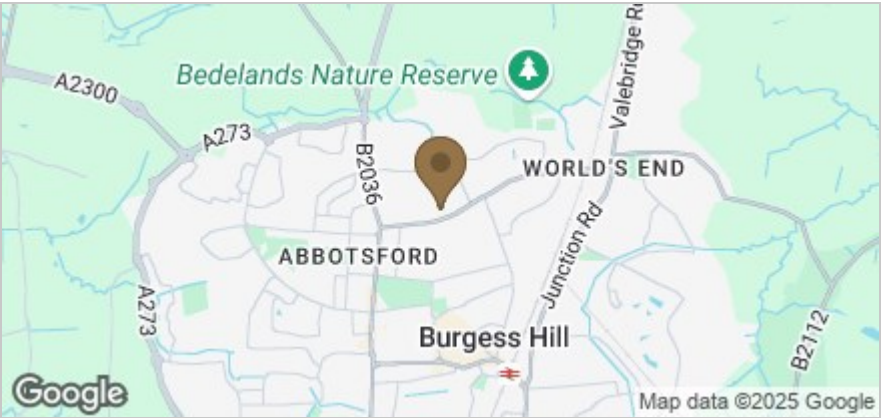

These particulars, whilst believed to be accurate are set out as a general outline only for guidance and do not constitute any part of an offer or contract. Intending purchasers should not rely on them as statements of representation of fact, but must satisfy themselves by inspection or otherwise as to their accuracy. No person in this firms employment has the authority to make or give any representation or warranty in respect of the property.

Accommodation

Duffy & Co are delighted to bring to the rental market this 3-bedroom mid-terrace house, ideally situated in a popular area of Burgess Hill. Located conveniently close to Wivelsfield Station and within easy reach of the local LIDL supermarket, this property offers tenants excellent access to transport links and everyday amenities.



Viewing

Please contact us on 01444 455221 if you wish to arrange a viewing appointment for this property or require further information.

Energy Efficiency Graph

