



**21 Harlands House, Haywards Heath, RH16 1LA**

**Guide Price £250,000**



Floor Plan

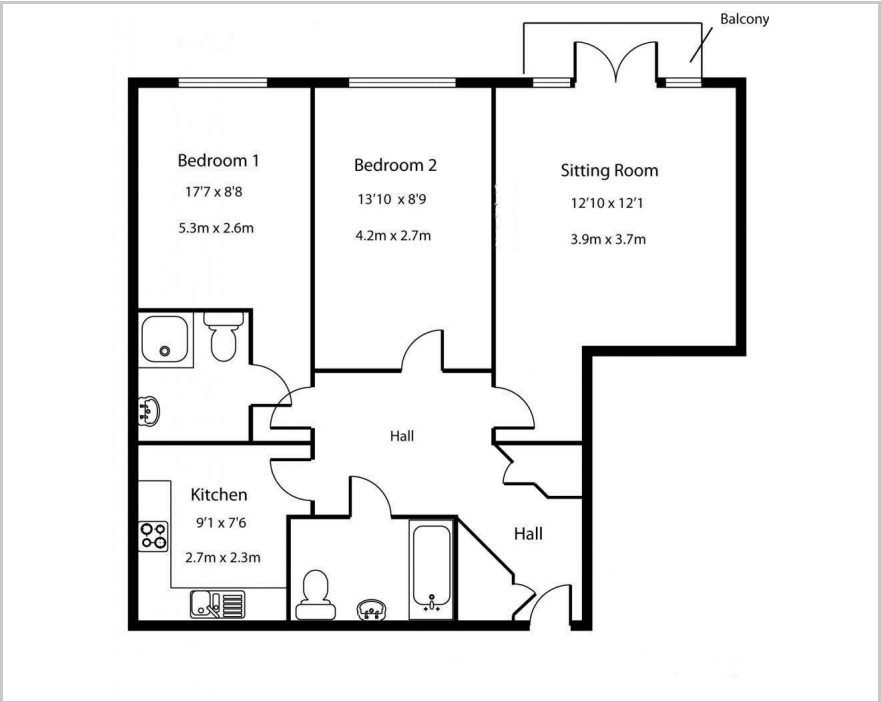

Area Map

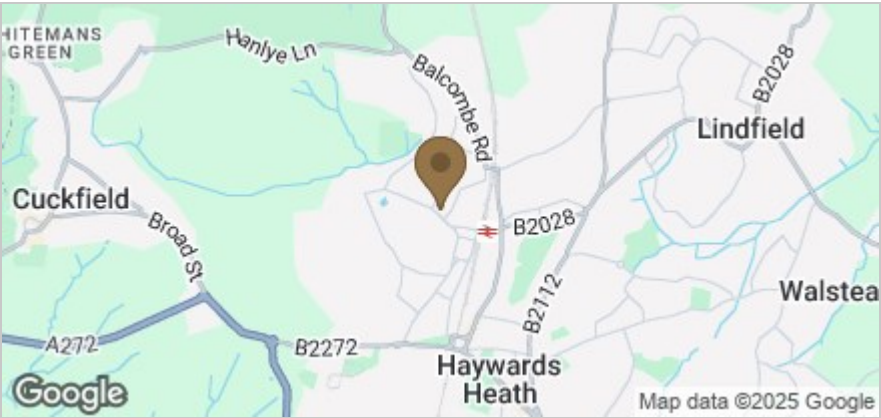

These particulars, whilst believed to be accurate are set out as a general outline only for guidance and do not constitute any part of an offer or contract. Intending purchasers should not rely on them as statements of representation of fact, but must satisfy themselves by inspection or otherwise as to their accuracy. No person in this firm's employment has the authority to make or give any representation or warranty in respect of the property.

Accommodation

Well-presented second-floor apartment offering excellent commuter convenience just moments from Haywards Heath mainline station. Features two double bedrooms, two bathrooms, private balcony, and allocated parking space. Ideal for professionals seeking easy access to London and Brighton rail links.

Walking distance to mainline station, 2 double bedrooms, 2 bathrooms, Second floor position, Private balcony, Allocated parking

Guide Price: £250,000 - £265,000

Perfect for first-time buyers or investors looking for a low-maintenance property with strong transport links. Ready to move into with no onward chain complications.

Viewing

Please contact us on 01444 455221 if you wish to arrange a viewing appointment for this property or require further information.

Energy Efficiency Graph

